



Nikko-Rack

<Applicable models>
 • NKAJ-0531R-G/SR-G
 • NKAJ-0733R-G/SR-G
 • NKAJ-0539R-G/SR-G
 • NKAJ-0546R-G/SR-G
 • NKAJ-0525R-G400/SR-G400
 • NKAJ-0531R-G400/SR-G400
 • NKAJ-0733R-G400/SR-G400







NIX,INC. Assembly Manual (Large-size)

Read this manual carefully before assembling.

Operating precautions

1. Do not use organic solvents such as washing soap, screw locks, grease, etc. May cause deformation or damage.
2. Do not step on the product or sit down. Otherwise it may be damaged and you may get injured.
3. Do not throw the product or not give a strong impact. Otherwise, the product may be deformed or damaged.
4. Do not expose the product to direct sunlight or ultraviolet light. Otherwise, the product may be deformed or damaged.
5. Be sure to check the lever lock when moving. The movable part may move unexpectedly and pinch fingers, etc.
6. Do not put the product in a high-temperature drying oven. Otherwise, the product may be deformed or damaged.
7. Be careful of the sharp tip of the part when reassembling, etc. Otherwise you may get injured.

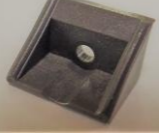
Parts list

①-A Guide rail unit A... 1 unit 	①-B Guide rail unit B... 1 unit 	⑦ Square washer ... 8 pcs 	⑧ Nylon rivet ... 2 pcs 
		⑨ AJ slope ... 4 pcs 	⑩ S-tight screw ... 2 pcs (white) 
			⑪ B-tight screw ... 2 pcs (yellow) 

② Base... 2 pcs 	③ Guide Channel U ... 4 pcs 
	④ Rack ... 4 pcs 
⑤ Hexagon socket head cap screw ... 14 pcs 	⑥ Round washer... 4 pcs 

Components' configuration

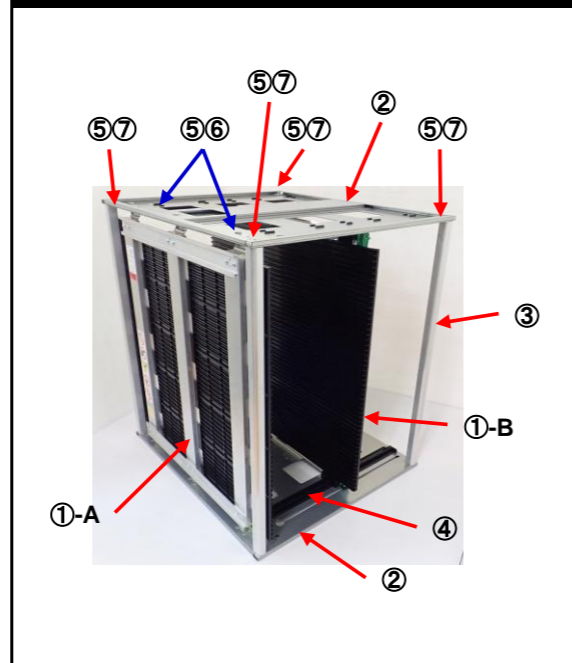

Assembly procedure

1 Mounting of Rack

Mount the ④ Rack on the ② Base.
 Into the outer square hole after inserting the protrusion into the inner square hole,
 ※There is no clearance between the base and the rack, push the tab in.

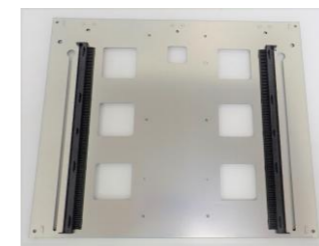
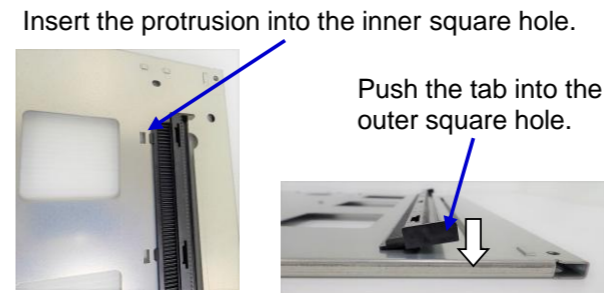

Rack installed

2 Installing the Guide channel U

Install the ③ Guide channel U at the position of the ② base as below photo, with the ⑤ Hexagon socket head cap screws M6X16 and ⑦ Square washer.
 ※Make sure that the installation position is correct.

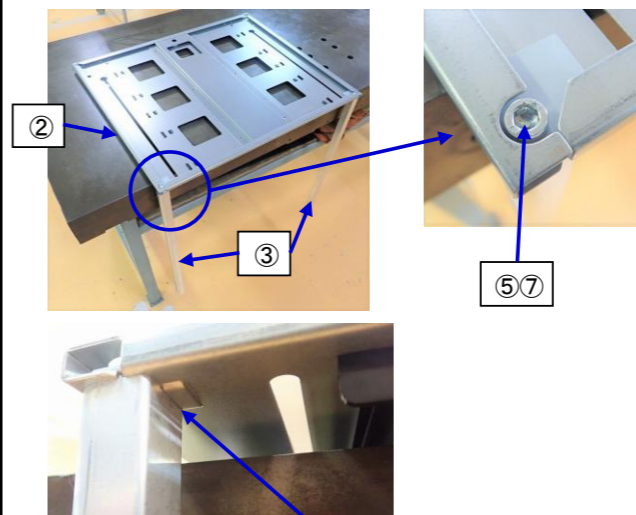

Tighten the ⑤ Hexagon socket head cap screws M6X16, so that the ③ Guide channel U hits the base protrusion.

3 Mounting 1 of the Guide rail unit B (movable side)

Set the ①-B Guide rail unit B with "Assy-2" .
 (Make sure that "upper mark" is upper side).
 Then, temporarily tighten the ② Base with the ⑦ Square washer and ⑤ Hexagon socket head cap screws M6X16.

※if there is no "UP mark", place the sculptured letter of the article in a readable orientation.

At this time, please make sure that the upper and lower sides of the ①-B Guide rail unit B (movable side) .

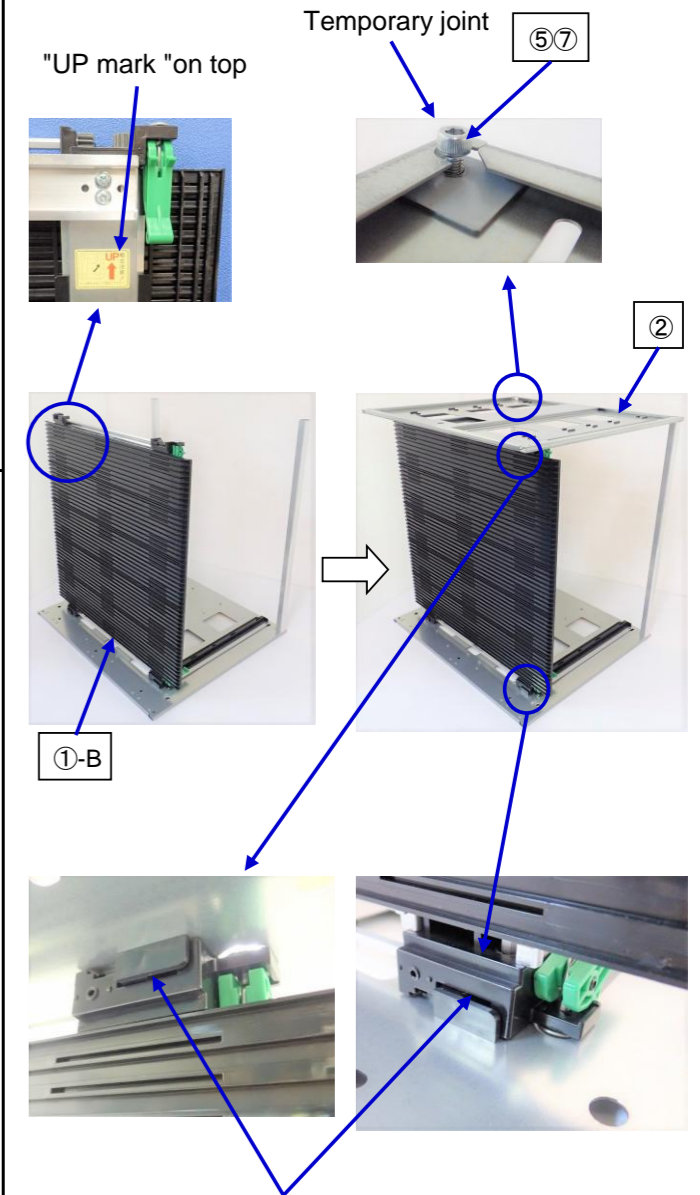

The four corner joints above and below, It hits the wall of the rack.

Tightening tool: Hex wrench (2-sided width: 5 mm), tightening torque: 2.70 ± 0.25 N·m (2.45-2.95 N·m)

This product is compliant with the RoHS Directive.

4 Mounting 2 of the Guide rail unit B (movable side)

The ①-B Guide rail unit B (movable side) moves to the vicinity of the center of the base while lifting the lock lever up. Then lock the all lock levers.
 Place ①-A Guide rail unit A (fixed side) ("Up mark" is upper side)
 Temporarily tighten it with the ⑤Hexagon socket head cap screws M6X16 to the ⑥Square washer.
 ※Fix the ①-A Guide rail unit A (fixed side) to the protrusion of the base.
 Temporarily tighten the ③Guide channel U with the ⑤Hexagon socket head cap screws M6X16 and the ⑦Square washer.
 ※Fix the ③Guide channel U to the protrusion of the base.

<Note>

Move ①-B Guide rail unit B (movable side) to ③Guide channel U side.
 And, Make sure that the four positions above and below all are right position.

If there is some mis-position, move back the ①-B Guide rail unit B (movable side) to the wall of the opposite rack to re-align.

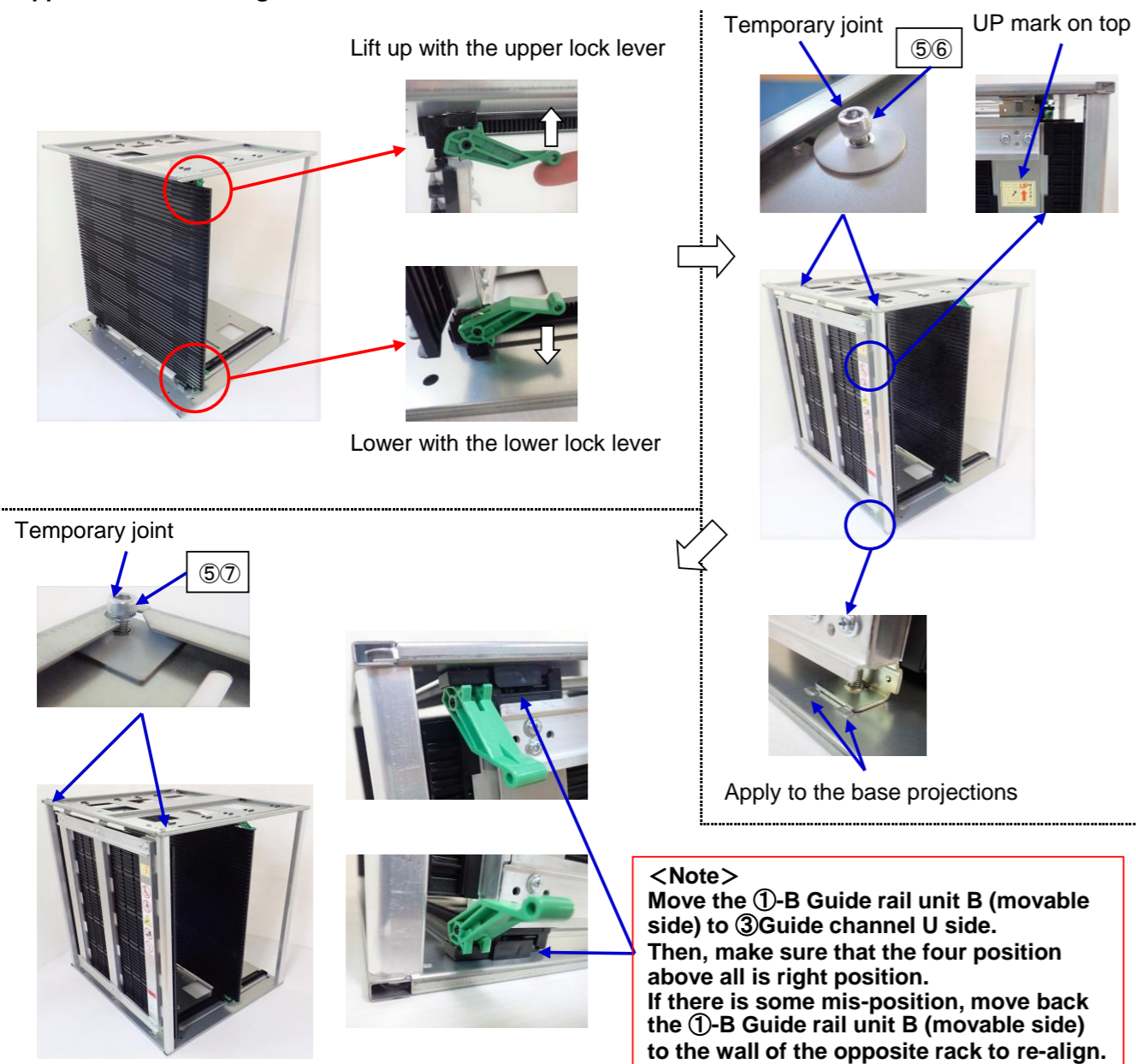

5 Mounting 3 of the Guide rail unit B (movable side)

Lock all the lock levers, and put "the assembly of 4" upside down, and then temporarily tighten the ①-A Guide rail unit A (fixed side) with ⑤Hexagon socket head cap screws M6X16 and ⑥Round washer.
 ※Fix ①-A Guide rail unit A (fixed side) to the protrusion of the base.
 Temporarily tighten the ③Guide channel U with ⑤Hexagon socket head cap screws M6X16 and the ⑦Square washer.
 ※Fix the ③Guide channel U to the protrusion of the base.

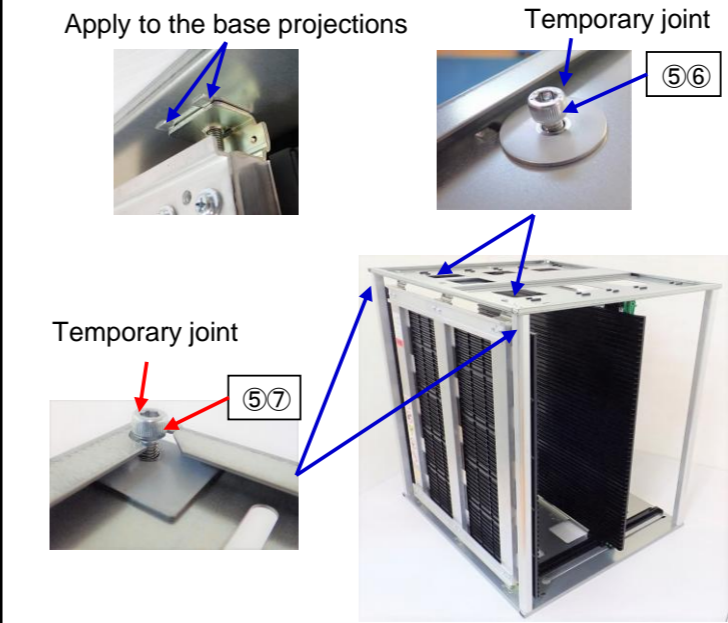

Installing the AJ Slope (Width adjustment easy)

⑨AJ slope is installed by a ⑩S-tight screw inside of the corner joint on the underside of the ①-A Guide-rail unit A (Fixed side).
 ⑨AJ slope is installed by a ⑪B-tight screw inside of the corner joint on the underside of the ①-B Guide-rail unit B (Movable side).
 ※Be careful because the screws type are different.
 ※Please refer to the our website for instructions on how to use the product.

URL : <http://www.nix.co.jp>

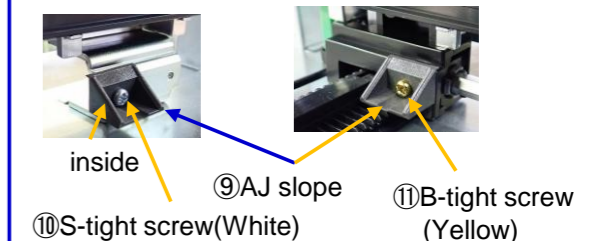

6 Final assembly

Please lay "the assembly of 5" sideways as picture below.
 Tighten the ⑤Hexagon socket head cap screws M6X16 with the ②Base pressed against the platen.
 (14 points in total on both sides) ※Tightening torque : 2.70±0.25 N·m (2.45-2.95 N·m)
 Insert ⑧Nylon rivet into the ②Base and push it in to prevent it from coming off.(2 points in total on both sides)
 ※Mount from outside to inside. (The stopper of the ①-B Guide rail unit B (movable side).)
 Finally, confirm that ①-B Guide rail unit B (movable side) operates smoothly.

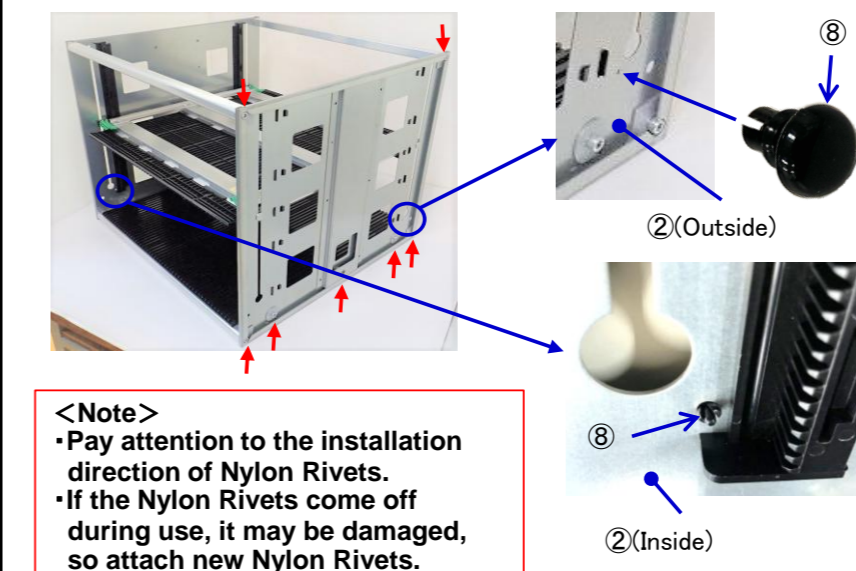

Completion

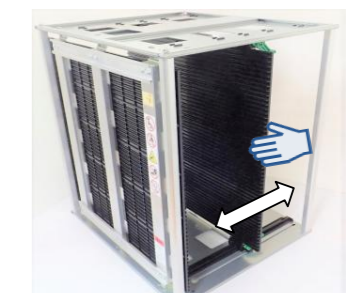

Please check, it move smoothly, by holding at the center of ①-B Guide rail unit B (movable side).

Tightening tool: Hex wrench (2-sided width: 5 mm), tightening torque: 2.70 ± 0.25 N·m (2.45-2.95 N·m)
 Cross screwdriver (number 2), ⑩S-tight screw tightening torque: 0.50±0.10 N·m (0.40-0.60 N·m)
 Cross screwdriver (number 2), ⑪B-tight screw tightening torque: 0.70±0.10 N·m (0.60-0.80 N·m)